

STANGENES INDUSTRIES CT 1.0 PULSE CURRENT TRANSFORMERS

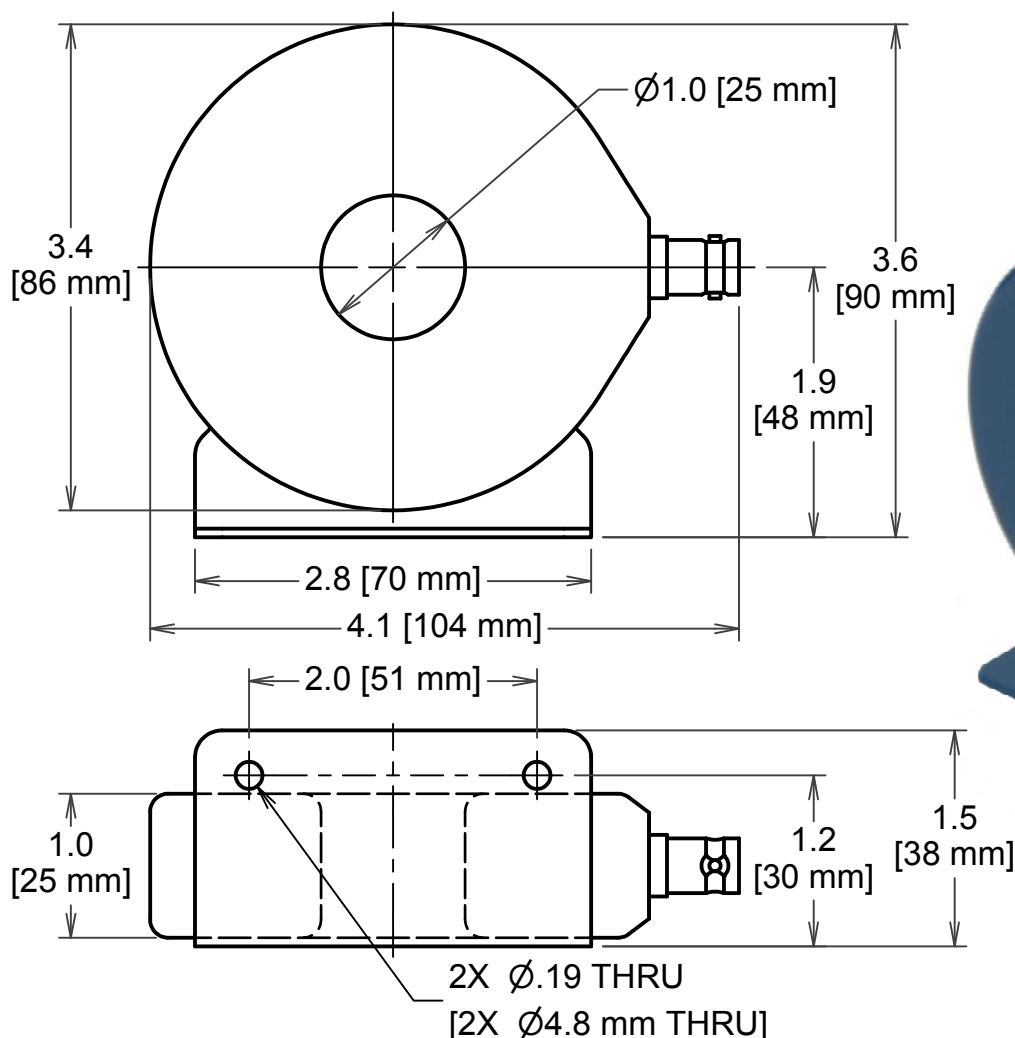

Model Number	Output (volt/amp) $\pm 0.5\%$	Maximum Current (amperes)		Square Pulse Characteristics			Sine-Wave Characteristics Approx. -3dB Point			RF Coaxial Jack
		Peak	RMS	Rise Time (nanosec.)	Drop (%)	$I \tau$ max. (amp-sec)	Low (Hz)	High (MHz)	I/F (peak A/HZ)	
1-1.0-R	1.0	500	7	20	0.1	0.006 *	130	30	0.02	Type BNC
1-0.1-R	0.1	5000	30	20	0.01	0.06 *	7	25	0.2	Type BNC

Specifications for transformation ratio, accuracy and droop are for a high impedance load.

Rise time and bandwidth are when terminated with 50 ohms.

All models are electrostatically shielded and have a 50 ohm output impedance.

Approximate weight: 0.93 Lbs. [0.42 kg]

We design and manufacture custom configurations in addition to the above. Contact the factory with your needs.

RoHS 2002/95/EC compliant.

* May need a small bias current through secondary for maximum rating.

STANGENES

INDUSTRIES INCORPORATED

The Best in High Voltage Systems & Electromagnetic Components

1052 East Meadow Circle, Palo Alto, CA, U.S.A. 94303

TEL: 650-493-0814 FAX: 650-855-9962 E-mail: info@stangenes.com

www.stangenes.com

