



3HVF10K

10kV, 2.5A, Fast Recovery
High Voltage Rectifier Block

Features

- Molded plastic body, ANSI/UL94 V-0 rated material
- Fast reverse recovery for efficiency
- RoHS compliant based on exemption: [2011/65/EC, Annex III, 7(a)]



Device Electrical Characteristics

(25°C ambient temperature unless stated otherwise)

	Conditions	Symbol	Value
Maximum Repetitive Peak Reverse Voltage		V_{RRM}	10,000 Volts
Average Forward Current Maximum	$T_A = 55^\circ\text{C}$	I_{FAVM}	2.5 Amps
Maximum Forward Voltage Drop	$I_F = 2.5 \text{ Amps}$	V_F	13 Volts
Maximum Reverse Current	$V_R = V_{RRM}$	I_R	0.5 μA
Maximum Reverse Recovery Time	$I_F = 0.5\text{A}; I_R = 1\text{A}; I_{rr} = 0.25\text{A}$	T_{RR}	250 ηsec
Maximum Surge Current	8.3msec, Half Sine	I_{FSM}	100 Amps
Maximum Junction Temperature	-	T_J	150°C
Storage Temperature Range	-	T_{STG}	-55°C to 150°C

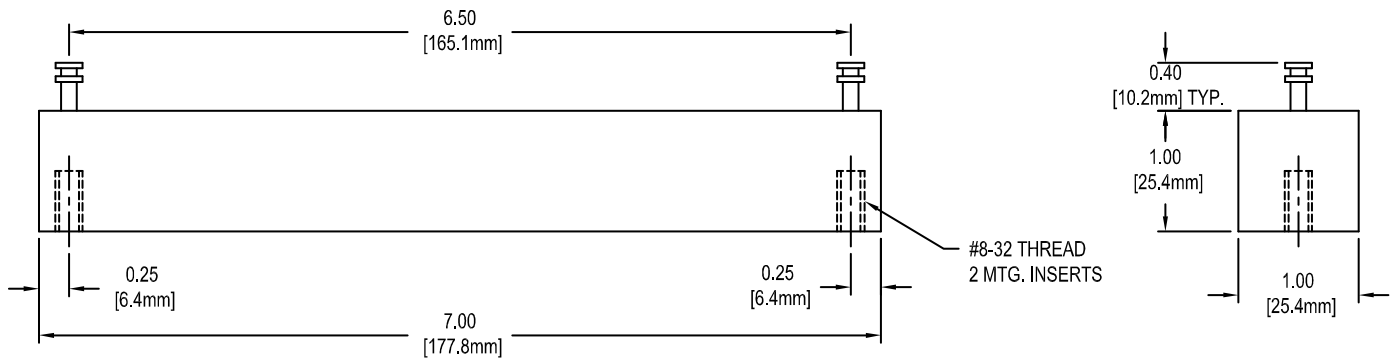

Dimensions are in Inches [millimeters]